

# FOR LEASE

## SOUTHFIELD INDUSTRIAL CENTER 5651 OLD DIXIE HIGHWAY, SUITE 100 4,464 SF AVAILABLE FOR LEASE



### BUILDING HIGHLIGHTS

- Total Building: 34,288 SF
- Available: 4,464 SF
- Office: 1,748 SF
- 18' Clear Height
- 35' Bay Width
- 120' Building Depth
- Two (2) Dock Doors
- Sprinklered Building
- 8 Auto Parking Spots

Owned by

**INDUSTRIAL**  
PROPERTY TRUST®



[industrialpropertytrust.com](http://industrialpropertytrust.com)

*Leased by*



**SEEFRIED**  
INDUSTRIAL PROPERTIES

Doug Smith

678.904.1919 Direct

[dougs@seefriedproperties.com](mailto:dougs@seefriedproperties.com)

Joseph Kriss

678.904.1910

[josephk@seefriedproperties.com](mailto:josephk@seefriedproperties.com)

**SOUTHFIELD INDUSTRIAL CENTER I 5651 OLD DIXIE HIGHWAY, SUITE 100**  
4,464 SF AVAILABLE FOR LEASE

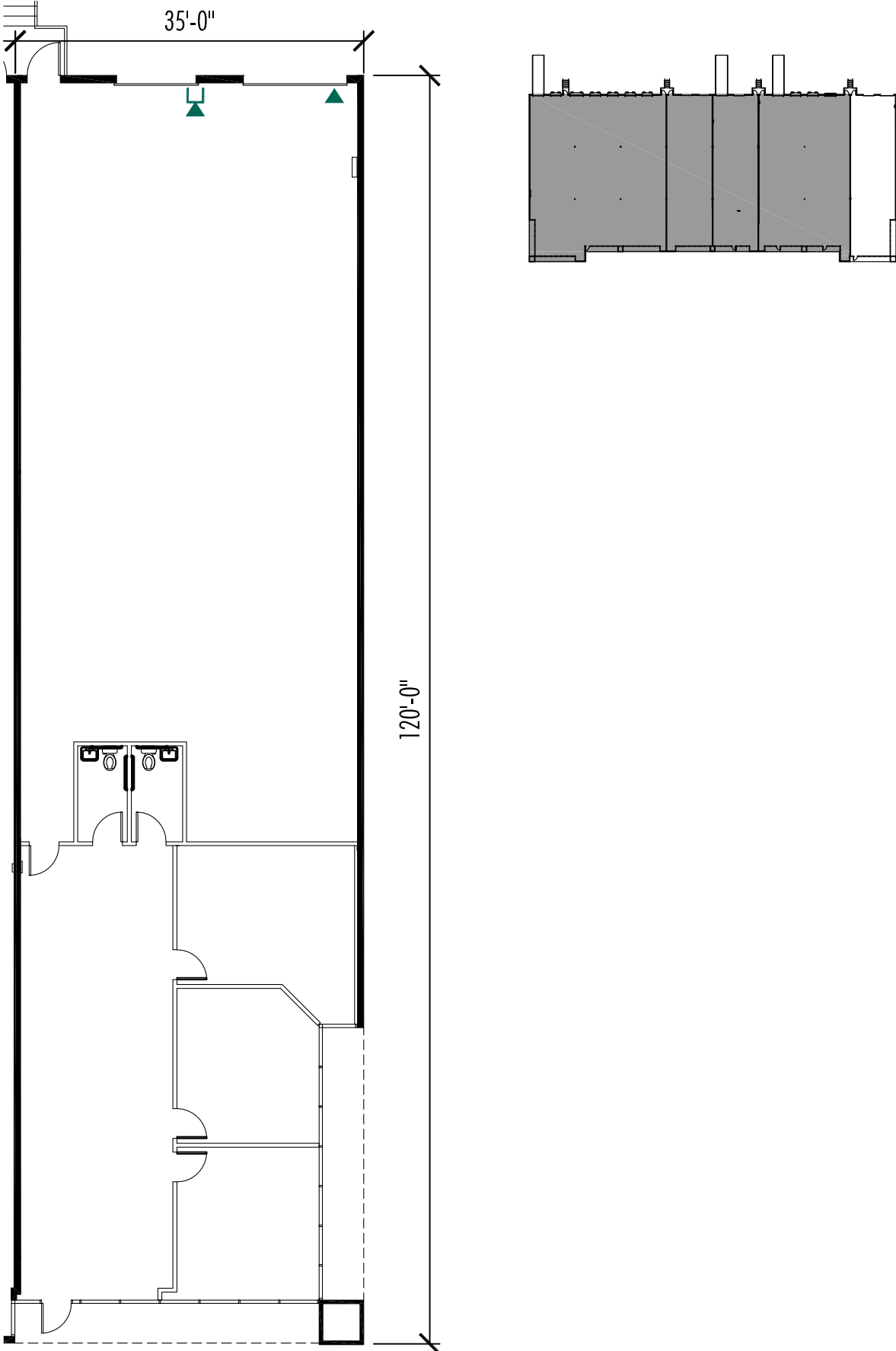

No guarantee, warranty or representation, express or implied, is made as to the accuracy of the information contained herein, and same is submitted subject to errors, omissions, change of price, rental or other conditions, or withdrawal without notice.