

# FOR LEASE

## SOUTHFIELD INDUSTRIAL CENTER 105 SOUTHFIELD PARKWAY, SUITE 100 48,053 SF AVAILABLE FOR LEASE



### BUILDING HIGHLIGHTS

- Total Building: 99,440 SF
- Available: 48,053 SF
- Office: 8,353 SF
- 24' Clear Height
- 40'x50' Column Spacing
- 200' Building Depth
- Fifteen (15) Dock Doors
- One (1) Ramped Drivein Door
- Sprinklered Building
- 45 Auto Parking Spots

Owned by

**INDUSTRIAL**  
PROPERTY TRUST®



[industrialpropertytrust.com](http://industrialpropertytrust.com)

*Leased by*



**SEEFRIED**  
INDUSTRIAL PROPERTIES

Doug Smith

678.904.1919 Direct

[dougs@seefriedproperties.com](mailto:dougs@seefriedproperties.com)

Joseph Kriss

678.904.1910

[josephk@seefriedproperties.com](mailto:josephk@seefriedproperties.com)

**SOUTHFIELD INDUSTRIAL CENTER I 105 SOUTHFIELD PARKWAY, SUITE 100**  
48,053 SF AVAILABLE FOR LEASE

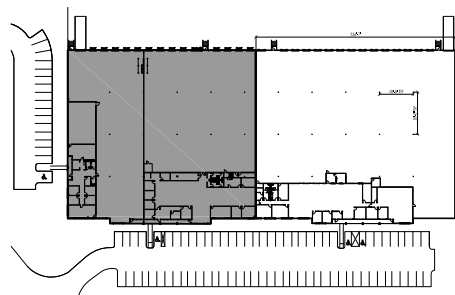
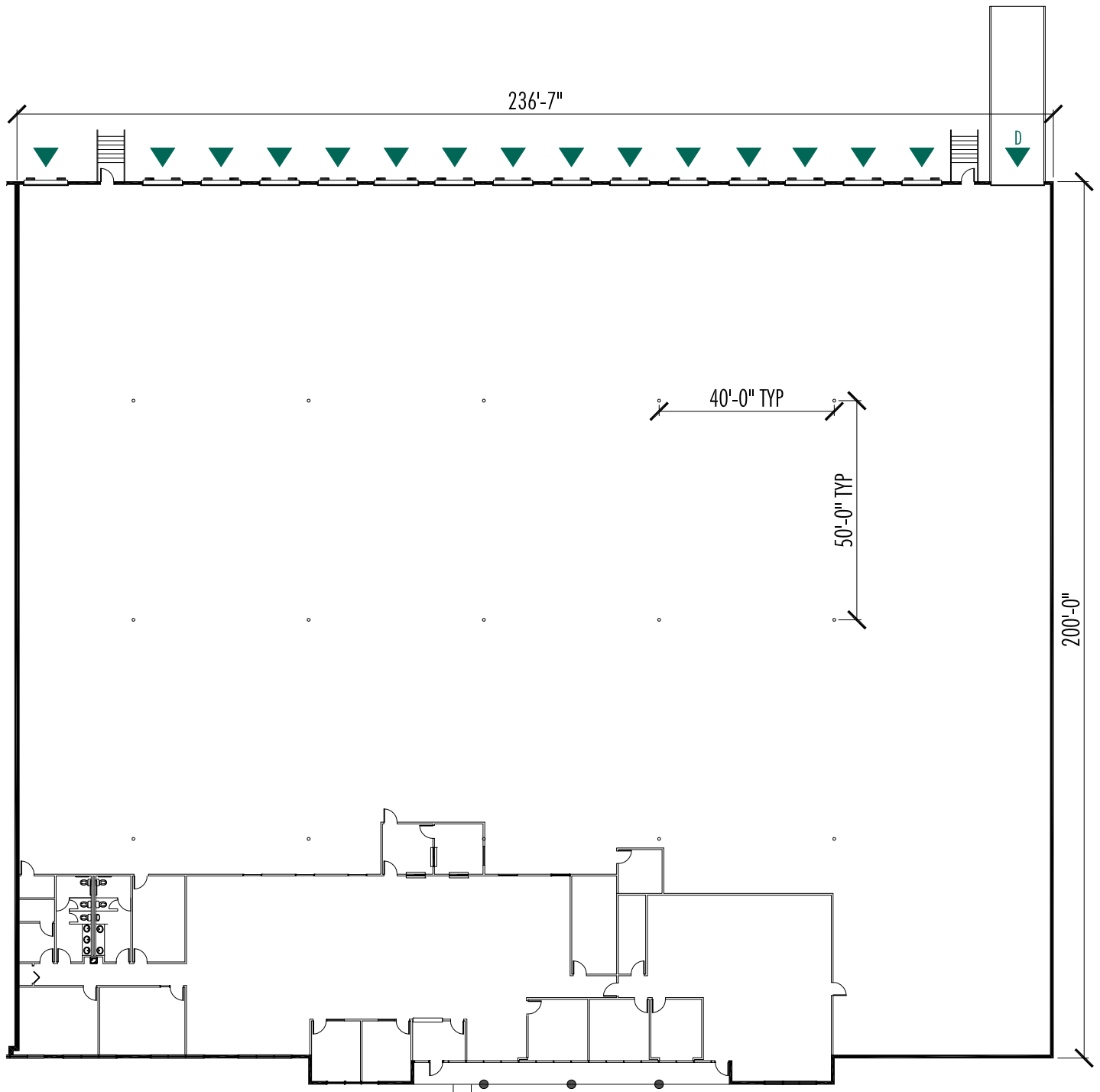

No guarantee, warranty or representation, express or implied, is made as to the accuracy of the information contained herein, and same is submitted subject to errors, omissions, change of price, rental or other conditions, or withdrawal without notice.