

AVAILABLE FOR LEASE

Gwinnett Park

4437 Park Drive, Suite A, Norcross, GA 30093



Building Specifications:

Space Available: 9,174 SF
Office Size: 1,943 SF
Ceiling Height: 24' Clear Average
Dock Doors: 1 Dock Door
1 Ramped Door
Sprinkler: Wet System
Column Spacing: 40' x 45'

*Excellent location with easy access to I-85 via
Beaver Ruin Road.*

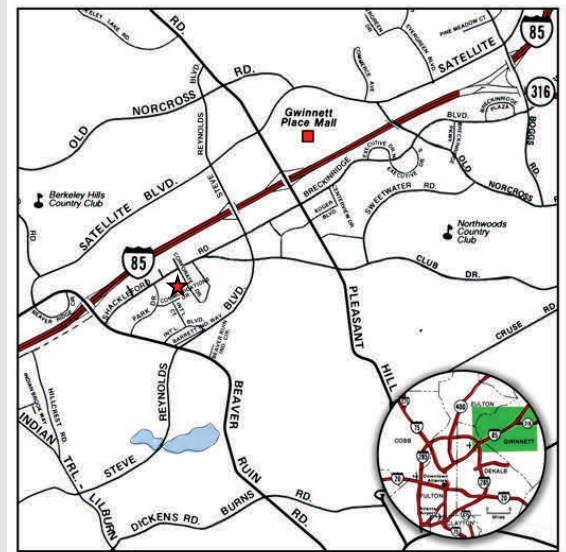

OWNED BY:



LEASED & MANAGED BY:



SEEFRIED INDUSTRIAL PROPERTIES, INC.

Doug Smith
(678) 904-1919

dougs@seefriedproperties.com

Joseph Kriss
(678) 904-1910

josephk@seefriedproperties.com

AVAILABLE FOR LEASE

Gwinnett Park

4437 Park Drive, Suite A, Norcross, GA 30093

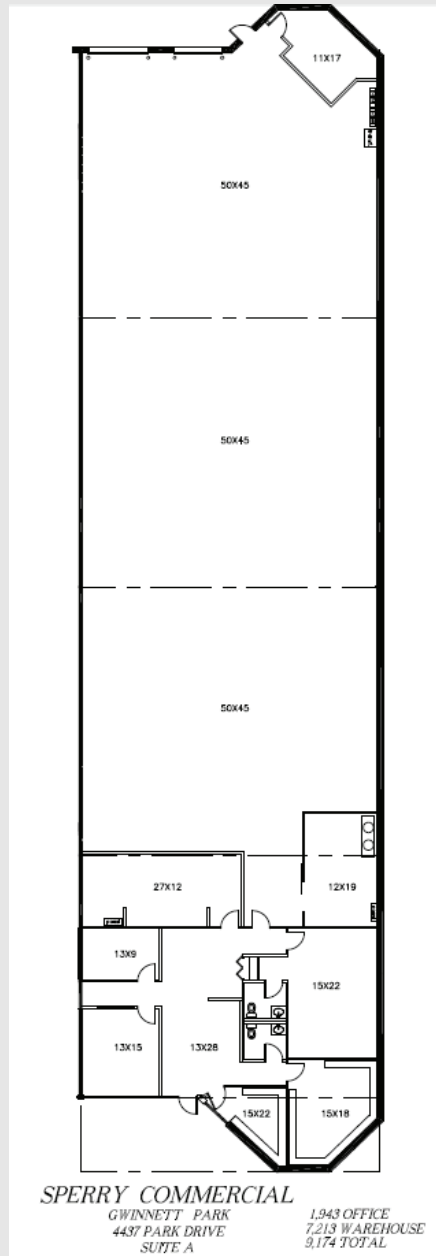

OWNED BY:



LEASED & MANAGED BY:

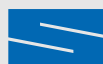

SEEFRIED INDUSTRIAL PROPERTIES, INC.

Doug Smith
(678) 904-1919

dougs@seefriedproperties.com

Joseph Kriss
(678) 904-1910

josephk@seefriedproperties.com