

174,074 SF for Lease

2200 Thornton Road

Lithia Springs, GA

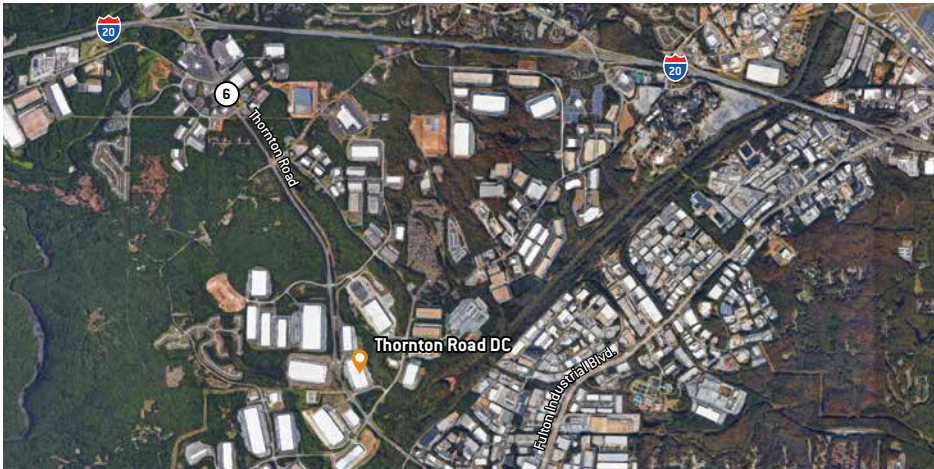

Building Features

- » 174,074 SF for lease
- » Loading: 25 dock doors, 3 Drive-in
- » Sprinkler: ESFR
- » Built: 2007
- » Total Available: 174,074 SF
- » Total Building Size: 476,086 SF
- » Total office: 9,137 SF
- » Clear Height: 32'
- » Column Spacing: 54' x 60'
- » Lighting: T5s
- » Trailer Spaces: 22 existing
- » Cross-dock configuration

No guarantee, warranty or representation, express or implied, is made as to the accuracy of the information contained herein, and same is submitted subject to errors, omissions, change of price, rental or other conditions, or withdrawal without notice.



3333 Riverwood Parkway, Suite 200

Atlanta, GA 30339

404.233.0204

www.seefriedproperties.com

Doug Smith

678.904.1919 Direct

dougs@seefriedproperties.com

Joseph Kriss

678.904.1910 Direct

josephhk@seefriedproperties.com

174,074 SF for Lease

2200 Thornton Road

Lithia Springs, GA

Floorplan

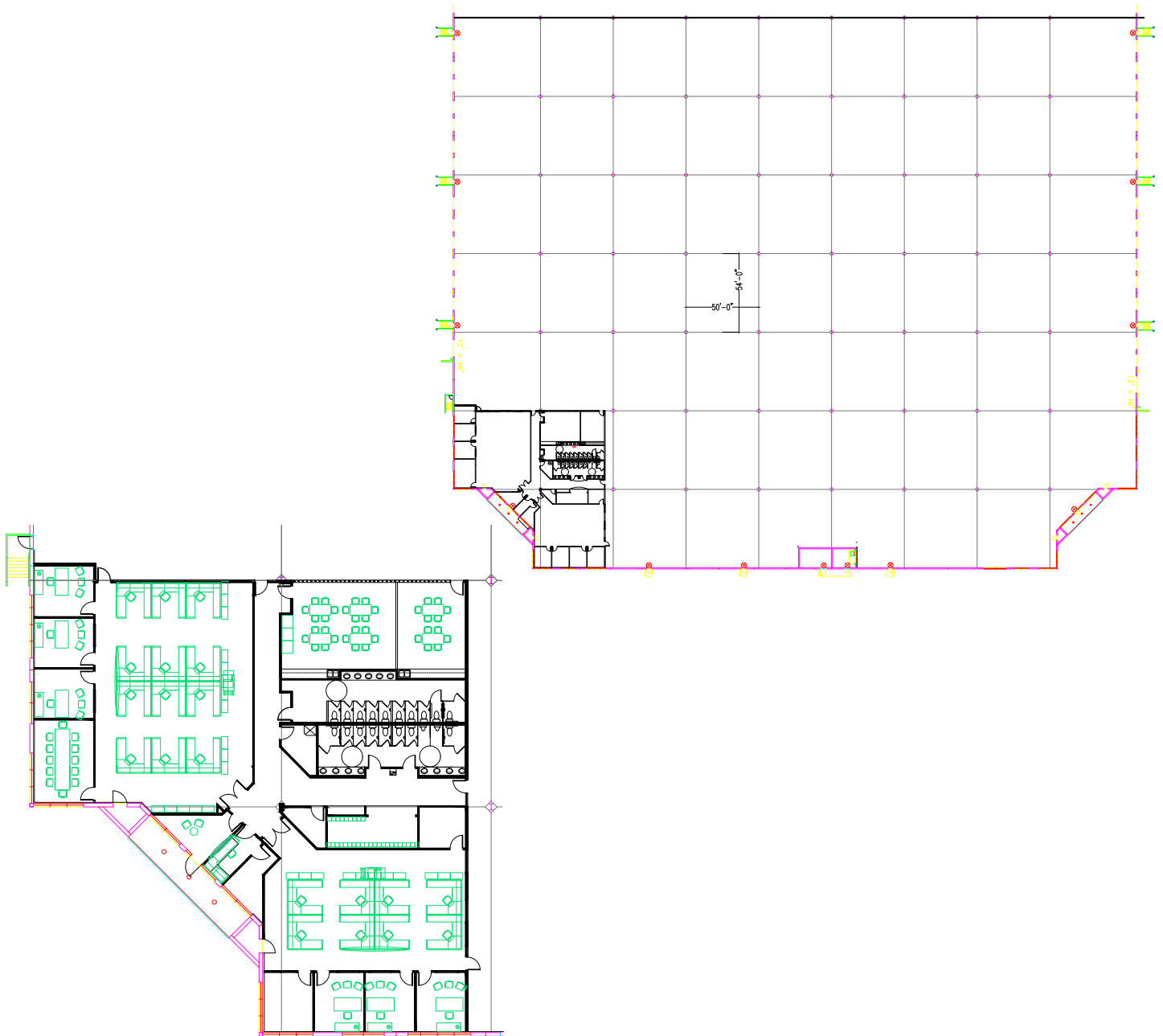

3333 Riverwood Parkway, Suite 200

Atlanta, GA 30339

404.233.0204

www.seefriedproperties.com

Doug Smith

678.904.1919 Direct

dougs@seefriedproperties.com

Joseph Kriss

678.904.1910 Direct

josephk@seefriedproperties.com