

AVAILABLE FOR LEASE

Atlanta Southern Business Park

1336 Citizens Parkway, Morrow, GA



Building Specifications:

Space Available:	10,317 – 24,080 SF
Office:	2,276 – 12,240 SF
Ceiling Height:	20' Clear
Dock Doors:	7 (8'x10') doors
Van-height Doors:	2 (8'x10') doors
Grade-level Door:	4 over-sized doors
Column Spacing:	42' x 40'
Lighting:	Metal Halide Existing

Excellent location with easy access to I-75 via Jonesboro Road.

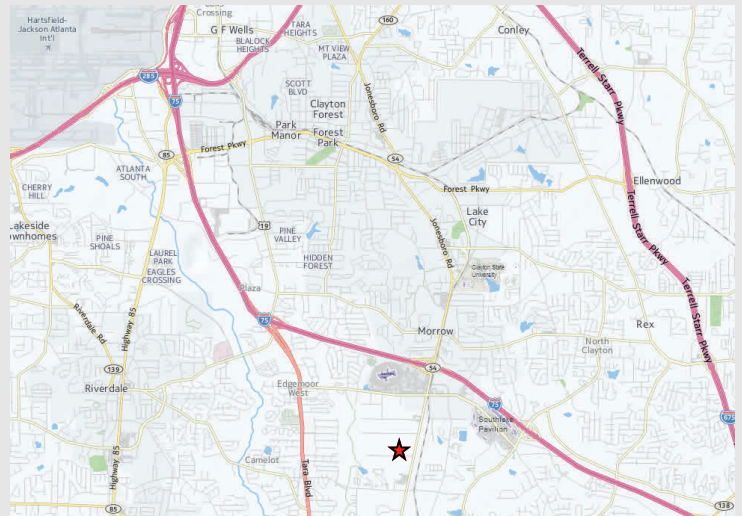

LEASED BY:



SEEFRIED INDUSTRIAL PROPERTIES, INC.

Doug Smith
(678) 904-1919

dougs@seefriedproperties.com

Joseph Kriss
(678) 904-1910

josephk@seefriedproperties.com

AVAILABLE FOR LEASE

Atlanta Southern Business Park

1336 Citizens Parkway, Morrow, GA

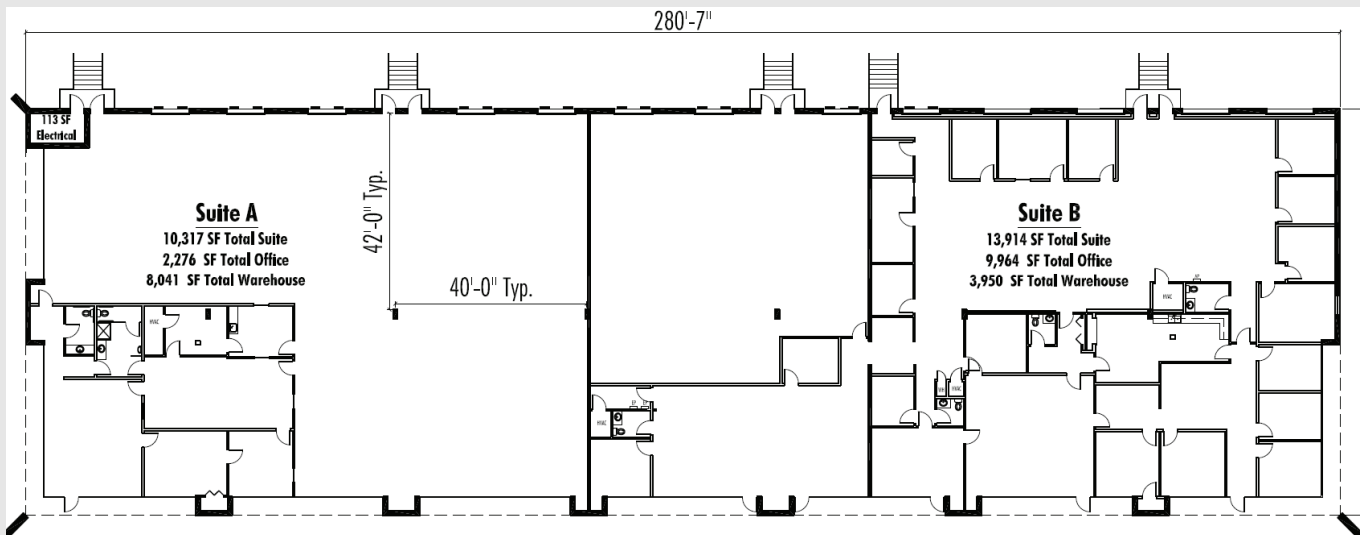

LEASED BY:



SEEFRIED INDUSTRIAL PROPERTIES, INC.

Doug Smith
(678) 904-1919

dougs@seefriedproperties.com

Joseph Kriss
(678) 904-1910

josephk@seefriedproperties.com