

AVAILABLE FOR LEASE

Perimeter West

1055 Research Center Drive, Atlanta, GA 30331



Building Specifications:

Space Available: 65,280 SF
Office Size: Approx. 8,000 SF
Ceiling Height: 20' Clear Average
Loading Doors: 13 dock-high doors
1 drive-in door
Sprinkler: Wet System
Column Spacing: 40' x 40'

Excellent location with easy access to I-285 via Cascade Road.

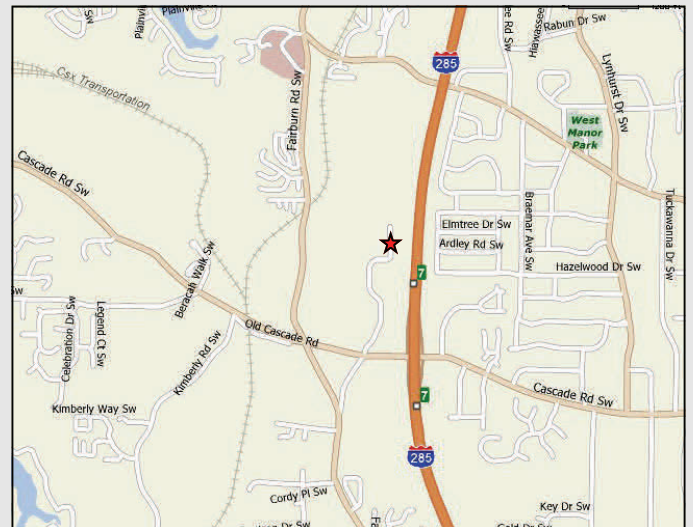

LEASED & MANAGED BY:



SEEFRIED INDUSTRIAL PROPERTIES, INC.

Doug Smith
(678) 904-1919

dougs@seefriedproperties.com

Joseph Kriss
(678) 904-1910

josephk@seefriedproperties.com

AVAILABLE FOR LEASE

Perimeter West

1055 Research Center Drive, Atlanta, GA 30331

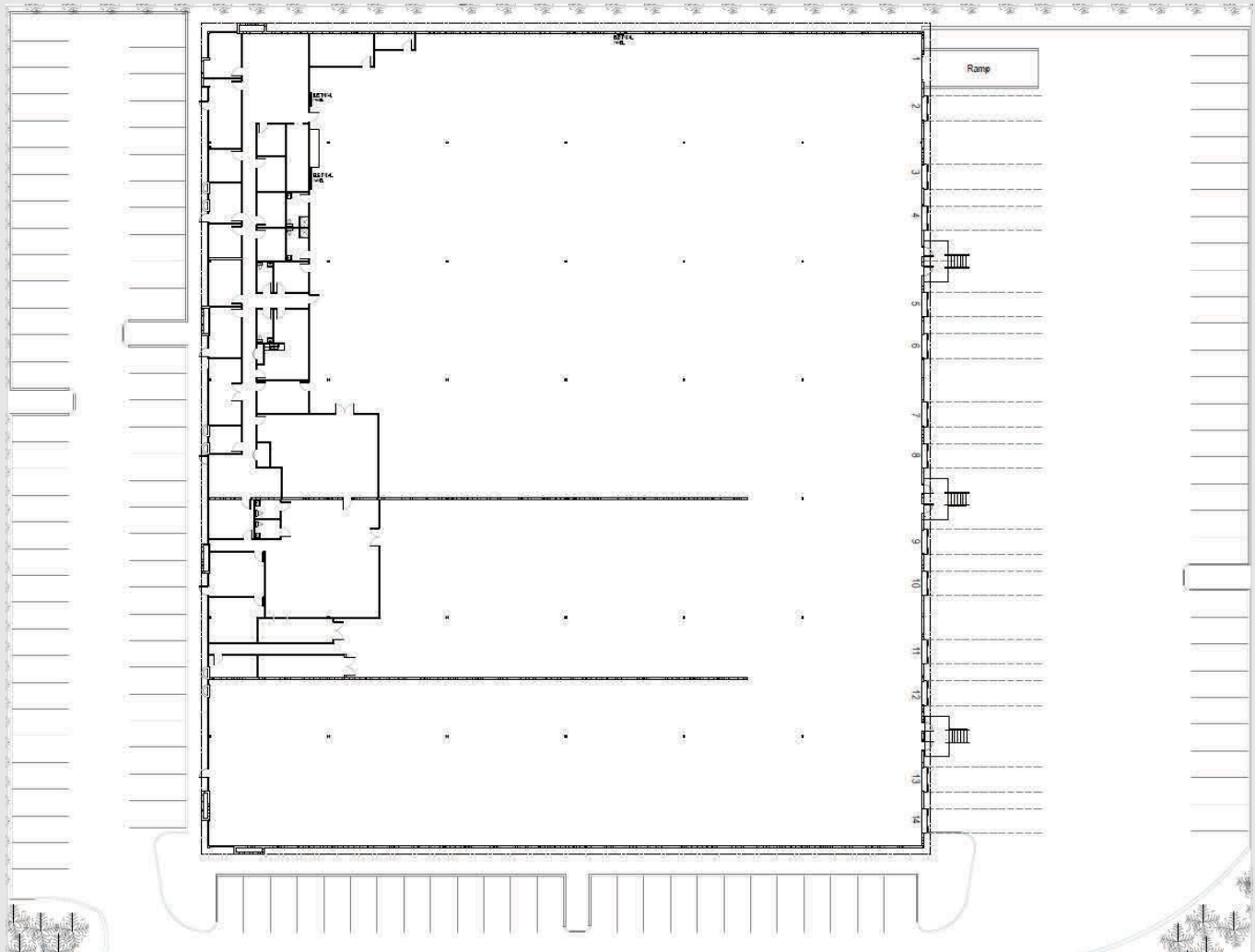

LEASED & MANAGED BY:



SEEFRIED INDUSTRIAL PROPERTIES, INC.

Doug Smith
(678) 904-1919

dougs@seefriedproperties.com

Joseph Kriss
(678) 904-1910

josephk@seefriedproperties.com