

AVAILABLE FOR LEASE

Perimeter West

1035 Research Center Drive, Suite C, Atlanta, GA



Building Specifications:

Space Available:	8,000 SF
Office Size:	1,411 SF
Ceiling Height:	20' Clear Average
Dock Doors:	2 Docks w/ levelers
Sprinkler:	Wet System
Column Spacing:	40' x 40'

Excellent location with easy access to I-285 via Cascade Road.

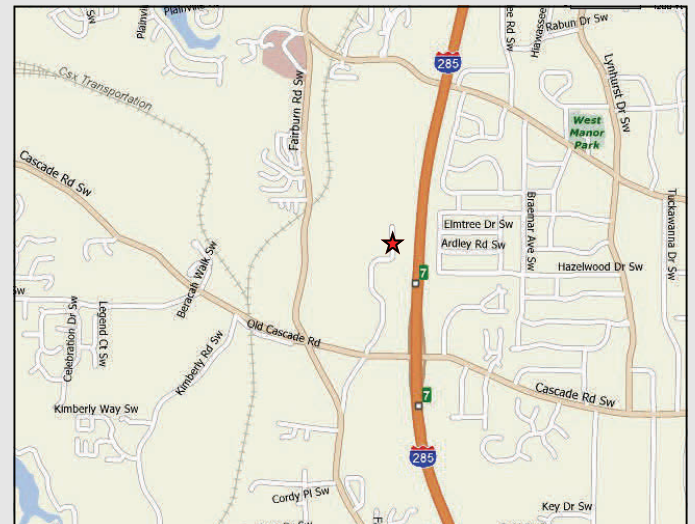

LEASED & MANAGED BY:



SEEFRIED INDUSTRIAL PROPERTIES, INC.

Doug Smith
(678) 904-1919

dougs@seefriedproperties.com

Joseph Kriss
(678) 904-1910

josephk@seefriedproperties.com

AVAILABLE FOR LEASE

Perimeter West

1035 Research Center Drive, Suite C, Atlanta, GA

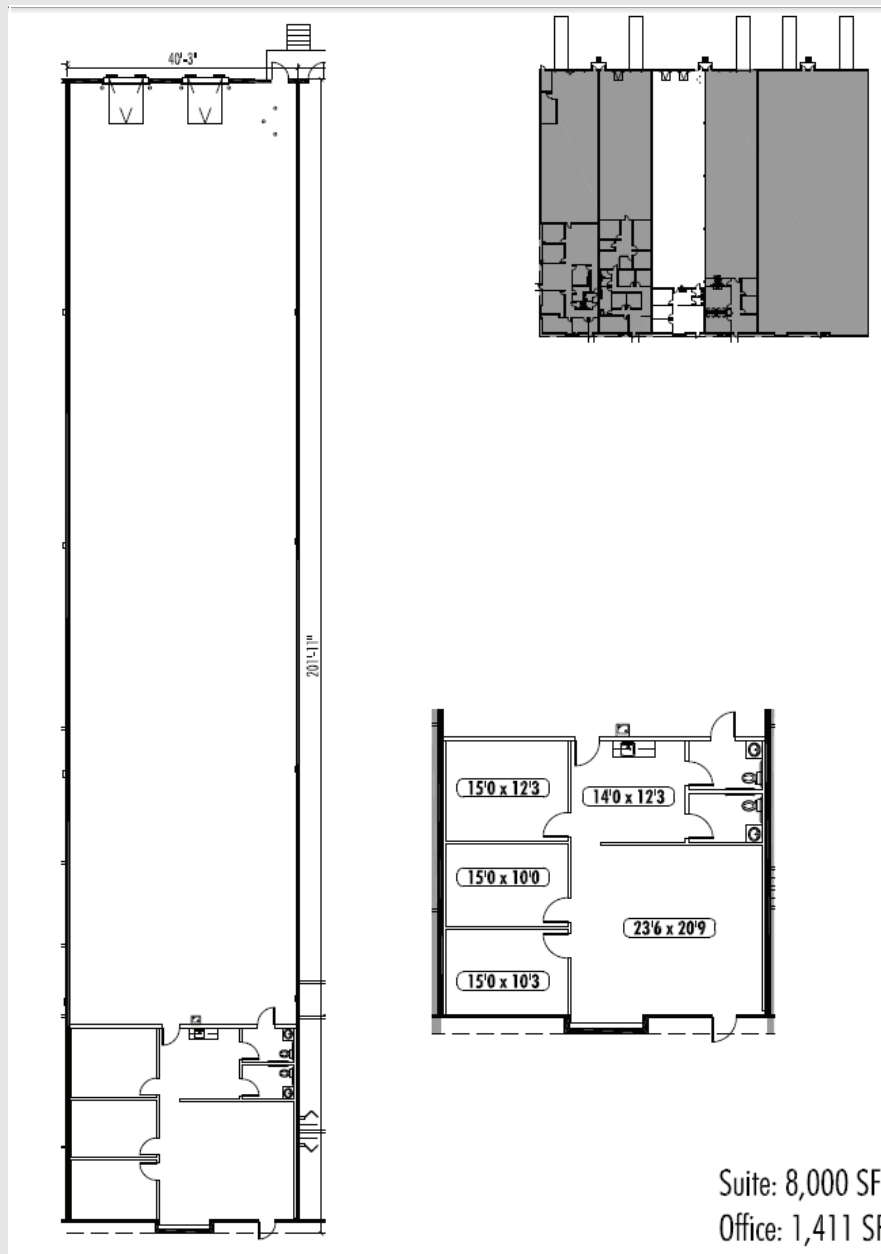

LEASED & MANAGED BY:



SEEFRIED INDUSTRIAL PROPERTIES, INC.

Doug Smith
(678) 904-1919

dougs@seefriedproperties.com

Joseph Kriss
(678) 904-1910

josephk@seefriedproperties.com